

Available Space For Lease

Catalpa Commons

11620 Catalpa Lane
Woodstock, IL 60098



1,400 sf Available For Lease

- 14,000 sf retail center with current tenants Great Clips, Cardinal Fitness, Verizon Wireless, and Chiro One Wellness Center.
- Strong mix of national and local tenants including: Menards, Farm and Fleet, and Super Wal-Mart.
- Double frontage



Midland Equities, LLC
One Trans Am Plaza, Suite 310
Oakbrook Terrace, Illinois 60181
Ph: 630.620.1500 - Fax: 630.620.1501

www.mideq.com

Available Space For Lease

Catalpa Commons 11620 Catalpa Lane Woodstock, IL 60098

Catalpa Commons is a 14,000 square foot retail center in Woodstock, Illinois. The property is located on the corner of Route 14 and Lake Avenue.

Tenant List:

Cardinal Fitness	Great Clips
Verizon Wireless	Chiro One
Vacant - 1,400 sf	Wellness Center

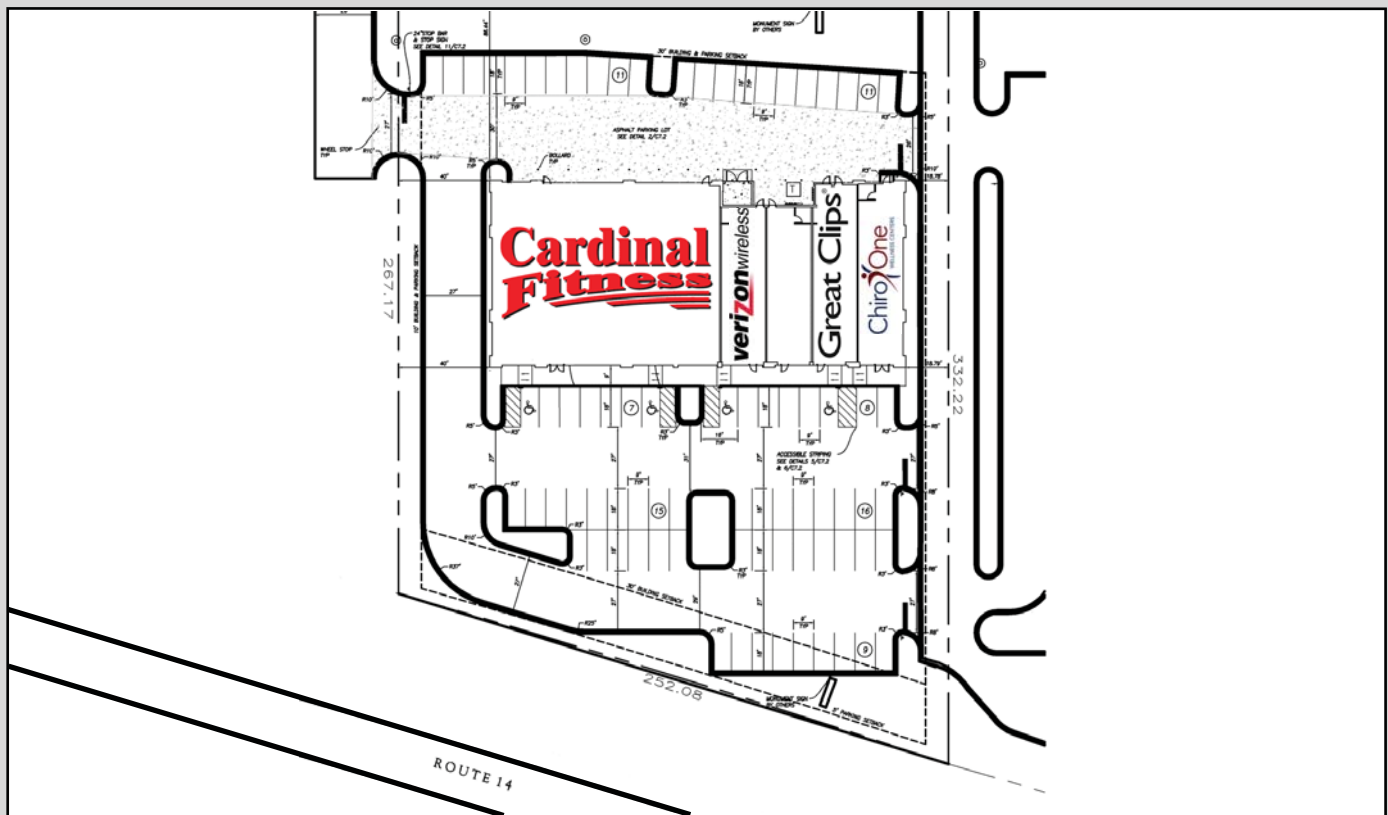

Mile Radius	Population	Avg. Household Income
1	2,485	\$71,925
3	22,117	\$77,844
5	35,232	\$90,735



Midland Equities, LLC
One Trans Am Plaza, Suite 310
Oakbrook Terrace, Illinois 60181
Ph: 630.620.1500 - Fax: 630.620.1501